

NOTES:

- 1) ELEVATIONS ARE ON AN ASSUMED DATUM.



SCALE: 1" = 15'

DISK

## EXISTING CONDITIONS PLAN

16 WEBSTER STREET  
 ROCKLAND, MA  
 PREPARED FOR  
 MARK HENDRICKSON

SCALE: 1" = 15'    DATE: 8/18/2023

LAND COURT PLAN 25251

#353-357  
N/F PATRICK J QUINN JR

PROPOSED (8)  
FULL-SIZE CAR  
PARKING

PROPOSED (3)  
COMPACT CAR  
PARKING

#28  
N/F OLD HARBOR  
REALTY LLC

PROPOSED  
2CY DUMPSTER

STOCKADE FENCE

PROPOSED  
PORTA-POTTY

#345-349  
N/F BINHCAITLYN LLC

LOT AREA= 14,947 SQ. FT.

PROPOSED  
8.5'x16'  
TACO TRAILER

BIT CONC  
DWY

BULKHEAD  
DOOR

TURF  
FIELD

#337-343  
N/F BINHCAITLYN LLC

STONE RETAINING WALL  
N12°27'05"W

MULCH

#16  
2 STORY  
WOOD

CONC PAD  
AG UNITS

PROPOSED  
15'x20'  
TENT WITH  
TABLE & CHAIRS

BIT CONC  
DWY

MULCH

MULCH

TURF  
FIELD

PAVER  
WALK

ENTRANCE

CHAIN-LINK FENCE (TYP)

BIT CONC SWK  
CONC CURB

**WEBSTER STREET**

EOP

CONC CURB

DISK

STREET PARKING AVAILABLE  
ON BOTH SIDES OF ROAD

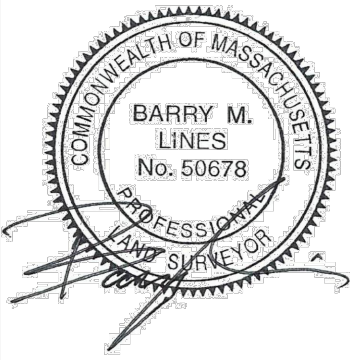

NOTES:

- 1) LOT OWNED BY: THE HAMMER COMPANIES
- 2) LOT IS ZONED: B-1
- 3) PROPERTY DEED BOOK 50013 PAGE 84
- 4) ELEVATIONS ARE ON AN ASSUMED DATUM.

**PROPOSED PLAN**

16 WEBSTER STREET  
ROCKLAND, MA  
PREPARED FOR  
MARK HENDRICKSON

SCALE: 1" = 20' DATE: 8/18/2023